



WILMINGTON²⁰₂₄
Grand Prix

Presented by:

BANK OF AMERICA 

RACE BIBLE

EVENT MANAGEMENT

EVENT DIRECTOR
EVENT DIRECTOR
RACE DIRECTOR
TIME TRIAL & CRITERIUM TECHNICAL DIRECTOR
GRAN FONDO TECHNICAL DIRECTOR
HOST HOUSING DIRECTOR
FINANCIAL DIRECTOR

JULIE MIRO WENGER
JERRY DU PHILY
LAURA VAN GILDER
BILL ELLISTON
STAN MARKWALDER
GABRIELLE REICHERT
JOANNE MIRO

EVENT PRODUCTION PERSONNEL

ANNOUNCERS
RACE REGISTRATION DIRECTOR
RACE HQ COORDINATOR
MEDICAL DIRECTOR
COURSE MARSHAL & VOLUNTEER COORDINATOR
TECHNICAL SUPPORT
TIMING AND RESULTS
STAGING & PRODUCTION
PACE CAR DRIVERS
PRODUCTION COORDINATOR
PR/COMMUNICATIONS DIRECTOR

BILL ELLISTON, GARY THORNTON
ANDREA RILEY
JOE & JOANNE MIRO
ST FRANCIS EMS
BEV ZIMMERMANN
PHILADELPHIA SERVICE COURSE
MAINSPORE EVENT SOLUTIONS
LIGHT ACTION/MAINSPORE
GREG ZIELINSKI
JOHN HOLTON
TSN MEDIA

EVENT MANAGEMENT • WILMINGTON GRAND PRIX

JERRY DU PHILY

EVENT ALLIES
164 CHRISTINA LANDING DR.
WILMINGTON, DE
302.897.6896

JULIE MIRO WENGER

EVENT ALLIES
164 CHRISTINA LANDING DR.
WILMINGTON, DE
302.545.8305

LAURA VAN GILDER

RACE DIRECTOR
307 A ST
WILMINGTON, DE
610.762.8408

OFFICIALS PANEL

CHIEF REFEREE

MIMI NEWCASTLE

CHIEF JUDGE

IXSA GOLLIHUR

ASSISTANT REFEREE

JIM FORT

MOTOR REFEREES

DAVID LAMB, JARED FERBER

RACE HEADQUARTERS**THE GRAND OPERA HOUSE****818 MARKET STREET****WILMINGTON DELAWARE 19801****302-652-5577****WWW.THEGRANDWILMINGTON.ORG****DIRECTIONS FROM I-95 (PHILADELPHIA AIRPORT)**

Take exit 7A toward DE-52 S/Delaware Ave 24.7
Merge onto W 11th St .2

To: Monkey Hill (Time Trial Start/Finish)

Take exit 7B toward DE-52 N/Delaware Ave .1
Turn right onto Gilpin Ave .1
Take the 1st right onto N Van Buren St .3
Slight right onto N Park .1
1001 North Park Drive
Wilmington, DE 19802

TIME TRIAL RACER PARKING & START INFO

- Behind Warner Elementary School (801 W 18th St, Wilmington, DE 19802)
- Baynard Stadium (1797 Stadium Dr, Wilmington, DE 19802)
- Salesianum School (1801 N Broom St, Wilmington, DE 19802)

TT Riders sent off by category in 30-second intervals. First rider off approximately 5:50pm**Start Order: Men's IV-V, Women's III-IV, Men's Masters, Men's II-III, Women's Pro, Men's Pro.*****To: The Grand Opera House (Race Headquarters & Criterium Start/Finish)***

Slight right onto Delaware Ave .5
Turn right onto N Market St .2
818 N Market St
Wilmington, DE 19801

CRITERIUM RACER PARKING (see site map)

- Limited Racer Parking at 1100 N. Market (adjacent to Rodney Square)
 - Racer Parking also available on King St (between 10th & 11th); Colonial Parking (6th & Orange sts.)
- Police will allow access into Market & King St. areas for logoed team cars and those with racer parking pass. Racer parking pass will be sent electronically to all pre-registered racers. No parking passes for those who register day of.

COMMUNICATION EQUIPMENT

- Radio communication equipment will be provided to race staff only in the form of Nextel radios. Teams are to provide their own equipment for internal communication.

VIP & MEDIA CREDENTIALS

- Credential Pickup

VIP, Race Staff, Media and Press credentials are available inside The Grand (818 Market St.)

VIP Hospitality Area (VIP wristband needed to access) in Sarah B. Parlor Room at The Grand (818 Market St.)

Credentials are required for course access, please wear credentials at all times. Course access is numbers and access is permitted to the areas that match the retrieval.

Improper use of credentials to help another person gain access to a secured area will result in the loss of credentials and immediate removal from the event.

MEDICAL INFORMATION / ANTI-DOPING (USADA)

The WGP event is subject to USADA Anti Doping Examination Regulations and all competitors and team personnel must abide by these regulations, any riders found positive will forfeit all prize money won at the event

Anti-Doping facilities will be located as follows:

Wilmington Grand Prix Headquarters
The Grand Opera House
818 Market Street
Wilmington, DE 19801

The List of riders required to report will be posted near the judge's stage and at the anti-doping facility.

Riders selected will not be announced prior to the race finish.

It is responsibility of the rider and/or his/her team personnel to check the postings and insure that the rider reports to the Anti-Doping within the required time.

Riders will be required to report to medical control within 30 minutes after the finish of the event or when applicable, 30 minutes after the awards and protocol ceremonies.

EVENT MEDICAL STAFF

The event will have EMT medical staff located at strategic areas of the Criterium course. EMT's can be reached by race radio. Medical Director: St. Francis EMS

AREA HOSPITAL

Wilmington Hospital
501 West 14th Street
Wilmington Delaware 19810

2024 WGP PRIZE LIST				
	MENS PRO	WOMEN PRO	Men CAT 2/3	Men CAT 4/5
	8000/25	8000/20	1500/20	600/12
1	2110	2110	420	180
2	1095	1095	210	90
3	730	730	135	60
4	510	510	105	45
5	415	415	85	40
6	345	345	75	40
7	300	300	65	30
8	265	265	55	30
9	235	235	50	25
10	210	225	45	25
11	190	220	40	20
12	180	210	40	20
13	155	195	35	
14	145	190	30	
15	135	180	30	
16	130	175	25	
17	120	170	25	
18	115	155	15	
19	110	150	15	
20	100	145	15	
21	95	CAT III Payout	Masters Payout	
22	90	Top 3: \$100, \$75, \$50	Top 3: \$100, \$75, \$50	
23	85			
24	80			
25	75			
	\$ 8,020.00	\$ 8,020.00	\$ 1,515.00	\$ 605.00

NEUTRAL TECHNICAL SUPPORT

Philadelphia Service Course handles the support services for Criterium Races only.

The neutral support is located at the Start/Finish of the Criterium Race (800 block Market Street)



DELAWARE GRAN FONDO & GOVERNOR'S RIDE

Sunday, May 19, 2024

Start location: Lookout Drive, Rockford Park Wilm., DE 19806

Start time: Mass start at 8am

Description:

A bucket-list ride through world-class attractions. A scenic but challenging 100-kilometer ride featuring 13 Brandywine Valley attractions. Unique opportunity to ride through the spectacular grounds of Hagley Museum and Winterthur Museum & Gardens.

Other route options include:

Medio Fondo (50k); Governor's Ride (24k)

Route options for all ability levels

Two-timed climbs for all Gran Fondo entrants with age-group medals for top 3 in each category.

Swag bag to all rides. Medals to all Fondo finishers. Official Delaware Gran Fondo T-shirt.

Post-ride BBQ with craft beer and giveaways.

For complete information on all rides or to register: www.wilmgrandprix.com
(registration fees increase closer to ride date)

Phone: 302/655-6483

CRIT COURSE & EVENT SITE MAP

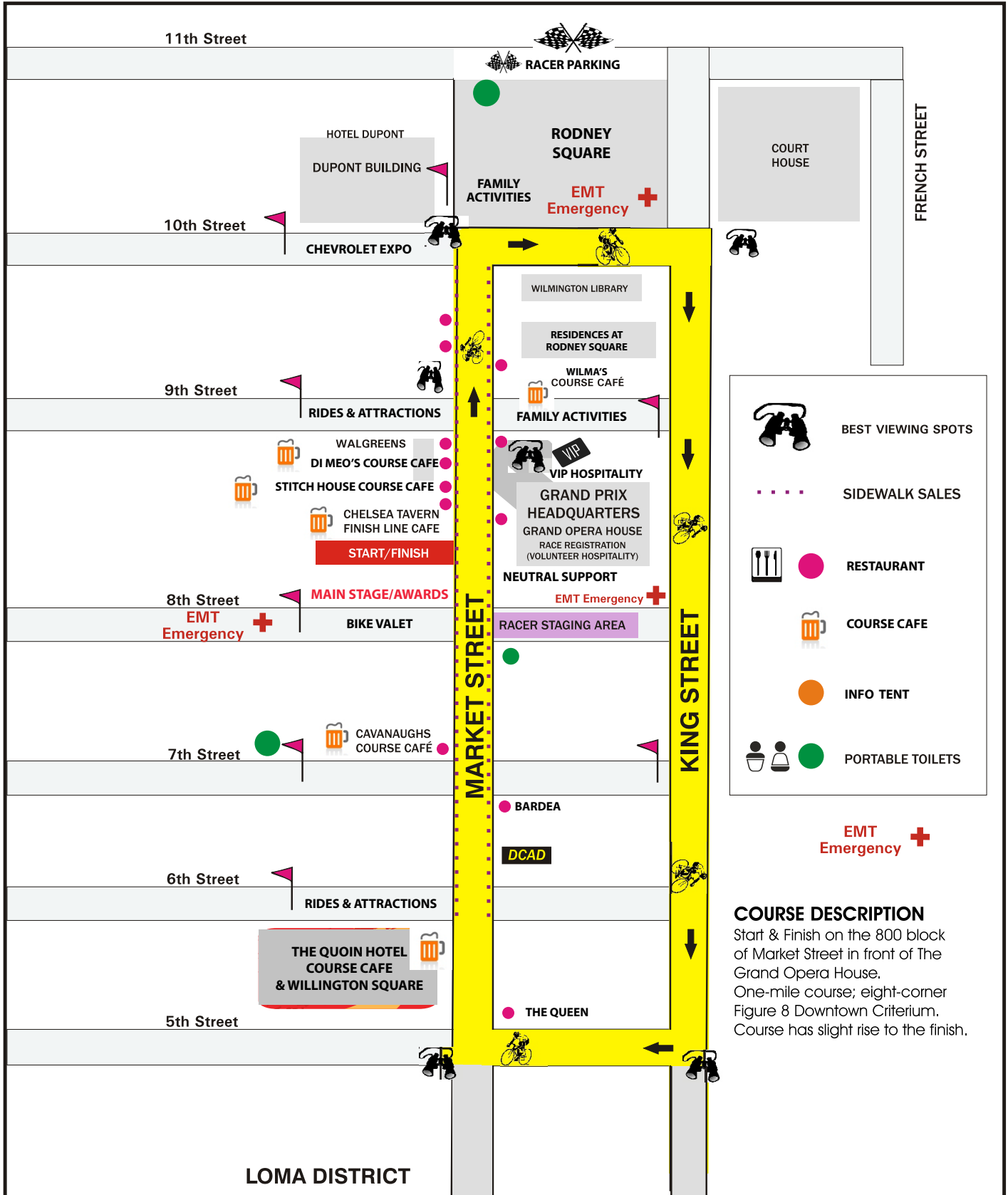



MONKEY HILL TIME TRIAL ROUTE

Wilmington Grand Prix

3.2-mile course starting on 18th St. (in front of Warner School) and proceeding through Brandywine Park.

- Left at Franklin Drive
- Left at Stadium Drive
- Right at N. Van Buren
- Right at S. Park Drive
- Left at Lovering Ave.
- Left at N. Van Buren
- Right at S. Park Drive
- Left at N. Market
- Left at N. Park Drive
- Right at N. Van Buren (Monkey Hill) to finish at 18th St.

Event Allies Presents

WILMINGTON GRAND PRIX

USA CYCLING

DOWNTOWN WILMINGTON, DELAWARE



PRO-AM TIME TRIAL & CRITERIUM

DOWNTOWN WILMINGTON, DELAWARE

MAY 17th & 18th, 2024

*** ALL FIELDS MUST HAVE MINIMUM OF 20 RACERS**

MEN'S PRO-1 CRITERIUM

EVENT	DISTANCE	START TIME	FEE	PRIZES	FIELD LIMIT
criterium *	35 Miles	1:45 pm	\$55.00	\$8,000.00/25	100

*Pro Team and Pro Continental riders may enter the Criterium

WOMEN'S PRO-1,2 CRITERIUM

EVENT	DISTANCE	START TIME	FEE	PRIZES	FIELD LIMIT
Criterium	25 Miles	4:15pm	\$55.00	\$8,000.00/20	90
Top 3 Category III payout (\$100, \$75, \$50)					

MEN'S IV-V CRITERIUM

EVENT	DISTANCE	START TIME	FEE	PRIZES	FIELD LIMIT
Criterium	45 Minutes	12:40pm	\$35.00	\$600/12	75

MEN'S II-III CRITERIUM

EVENT	DISTANCE	START TIME	FEE	PRIZES	FIELD LIMIT
Criterium	60 Minutes	3:05PM pm	\$40.00	\$1500/20	100
Top 3 Masters 45+ payout (\$100, \$75, \$50)					

STAGING AREA FOR ALL RACES IS E. 8TH STREET (SEE CRIT COURSE & EVENT SITE MAP). RACERS MUST REMAIN IN STAGING AREA UNTIL USAC OFFICIALS CALL RACERS TO THE START LINE. CALL-UPS WILL BE CONDUCTED.

APPROXIMATE TIMES FOR PODIUM PRESENTATIONS

(Failure to appear for podium presentation could result in forfeiture of prize money).

- **Men's IV-V** 2pm
- **Men's Pro-1:** 3:15pm
- **Men's II=III:** 4:10pm
- **Women's** 5:15pm (immediately following race finish)

COURSE DESCRIPTIONS:

Monkey Hill Time Trial

Time Trial starts at the crest of Monkey Hill, follows a technical 5K course around the Brandywine River and through Brandywine Park. It finishes with a challenging climb up the famed cobblestones of Monkey Hill. The course was originally made famous by the Tour DuPont in the 1990s.

Wilmington Grand Prix Criterium

Start & Finish on the 800 block of Market Street in front of the Grand Opera House. The course is .8-mile rectangular Downtown Criterium with slight rise into the finish.

Neutral Technical Support

Philadelphia Service Course handles the support services for Criterium Races only. No neutral support for Time Trial. The neutral support is located at the Start/Finish of the Criterium Race (800 block Market Street)

ALL USAC RULES APPLY * Held under USAC Event Permit 2024-8571

Day of Registration. Pre-Registration @ www.wilmgrandprix.com

- No day-of registration for Monkey Hill Time Trial. Pre-registration deadline May 15 at 11:30pm. TT check-in opens 4pm 5/17.
- Limited day-of registration for Criterium available (unless field limits met). \$10 late fee.
Inquire at Race Headquarters: **THE GRAND OPERA HOUSE (818 MARKET STREET; WILMINGTON, DE 19801)**
- Criterium registration/sign-in opens at 10:30am on 5/19; closes 15 minutes before each category's race start.

REGISTRATION QUESTIONS:

Laura Van Gilder (Race Director) @ lvgrb@ptd.net; 610.762-8408

GENERAL GRAND PRIX QUESTIONS:

Jerry duPhily jduphily@tsnpub.com; 302.655-6483

